

ProKure®

ClO₂ Technology

Protect Your Grow

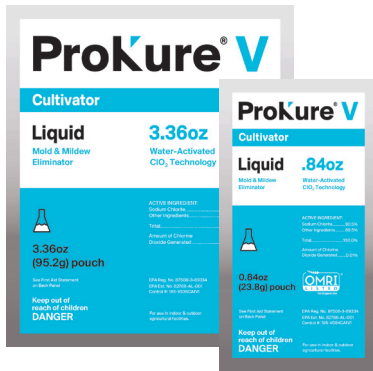

ProKure® V

OMRI and EPA Registered



LIQUID

Water-Activated

Kills odor-causing bacteria, mold and mildew
Suitable for use with plants in the room

Fungicide when used in spray form to eliminate mold from plants, leaves, fruits and vegetables

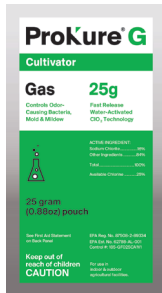

ProKure® G

EPA Registered



FAST RELEASE GAS

Water-Activated

Controls odor-causing bacteria, mold and mildew

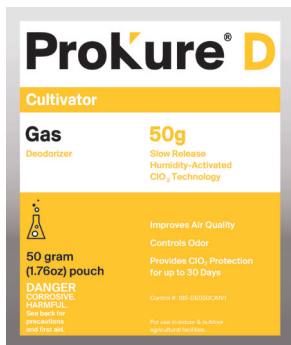

ProKure® D

EXTENDED RELEASE GAS

Improves air quality and controls odor
Provides ClO₂ Protection for up to 30 Days

Humidity-Activated



Product Details

ProKure® V

Product Category	Size	Item #	EPA Reg. #	Yields (at 100ppm)
Cultivator	3.36 ounces	185-V336C	87508-3-89334	20 gallons
	0.84 ounces	185-V084C	87508-3-89334	5 gallons
	0.17 ounces	185-V017C	87508-3-89334	1 gallon
	0.042 ounces	185-V0042C	87508-3-89334	1 quart

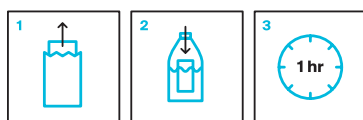

Directions for Use: Open the silver foil packet and remove the white pouch (DO NOT OPEN THE WHITE POUCH). Place the white pouch in an opaque (not clear) container filled with water. Allow pouch to activate in water for one hour to reach maximum strength.*

ProKure® G

Product Category	Size	Item #	EPA Reg. #	Coverage Area
Cultivator	25 grams	185-GF025C	87508-2-89334	2,250 cubic feet
	10 grams	185-GF010C	87508-2-89334	1,000 cubic feet

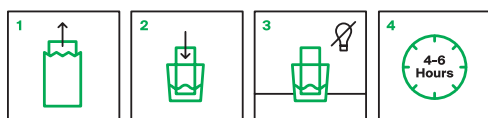

Directions for Use: Open the silver foil packet and remove the white pouch (DO NOT OPEN THE WHITE POUCH). Place the end of the white pouch that has the square indentations into a plastic cup filled with 1.5" of water. Place it on a stable, level surface in a central location (and turn off the lights). Allow at least 4 to 6 hours for the system to work. (Not recommended for more than 24 hours.)*

ProKure® D

Product Category	Size	Item #	Coverage Area
Cultivator	50 grams	185-DE050C	4,000 cubic feet
	10 grams	185-DE010C	1,000 cubic feet

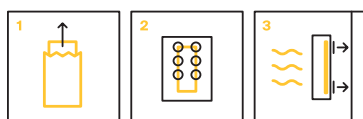

Directions for Use: Tear open this foil packet and remove the inner white pouch (DO NOT OPEN THE WHITE POUCH). Insert the white inner pouch into the clamshell. Snap the clamshell securely closed and place on a stable, level surface. You may also use the tape strips on the back of the clamshell to adhere to a wall.*